

FOR LEASE

COMMERCIAL KITCHEN/COLD STORAGE

26340 - 26370

DIAMOND PLACE

SANTA CLARITA, CA

2,000 - 9,300 SF



CanAm
Business Park

YAIR HAIMOFF, SIOR

Executive Managing Director
818.203.5429
yhaimoff@spectrumcre.com
CA DRE Lic. #01414758

CONNOR QUAN

Senior Associate
818.935.2683
cquan@spectrumcre.com
CA DRE Lic. #02103887

No warranty, express or implied, is made as to the accuracy of the information contained herein. This information is submitted subject to errors, omission, change of price, rental or other conditions, withdrawal without notice, and is subject to any special listing conditions imposed by our principals. Cooperating brokers, buyers, tenants and other parties who receive this document should not rely on it, but should use it as a starting point of analysis, and should independently confirm the accuracy of the information contained herein through a due diligence review of the books, records, files and documents that constitute reliable sources of the information described herein. Spectrum Commercial Real Estate, Inc. CA DRE #02042805

SPECTRUM
COMMERCIAL REAL ESTATE, INC.

spectrumcre.com | 818.252.9900

26340 - 26370

DIAMOND PLACE

SANTA CLARITA, CA

FEATURES / HIGHLIGHTS

PROPERTY FEATURES



Prime Location within Centre Pointe Business Park



Well Designed Units – All Ground Floor



Cold Storage Fully Insulated Units with Large Commercial Chillers



Equipped with Back-Up Generator



Ample Power



Ample Parking



16' – 18' Warehouse Clear



Excellent Loading



Building Signage



LOCATION HIGHLIGHTS

Located within a Master Planned Business Park



Adjacent to the New Cross Valley Connector (126)



Minutes from 14 & 5 Freeway Onramps



Minutes from Valencia Town Center Amenities



HYATT



LAIFITNESS

Walmart
Save money. Live better.



DICK'S
SPORTING GOODS

ASHLEY

THE HOME DEPOT

Pep Boys

Bank of America



YAIR HAIMOFF, SIOR

Executive Managing Director

818.203.5429

yhaimoff@spectrumcre.com

CA DRE Lic. #01414758

CONNOR QUAN

Senior Associate

818.935.2683

cquan@spectrumcre.com

CA DRE Lic. #02103887

No warranty, express or implied, is made as to the accuracy of the information contained herein. This information is submitted subject to errors, omission, change of price, rental or other conditions, withdrawal without notice, and is subject to any special listing conditions imposed by our principals. Cooperating brokers, buyers, tenants and other parties who receive this document should not rely on it, but should use it as a starting point of analysis, and should independently confirm the accuracy of the information contained herein through a due diligence review of the books, records, files and documents that constitute reliable sources of the information described herein. Spectrum Commercial Real Estate, Inc. CA DRE #02042805

SPECTRUM
COMMERCIAL REAL ESTATE, INC.

spectrumcre.com | 818.252.9900

SANTA CLARITA, CA

SPECTRUM
COMMERCIAL REAL ESTATE, INC.
spectrumcre.com / 818.252.9900

26340 - 26370

DIAMOND PLACE

SANTA CLARITA, CA

SIZING BREAKDOWN

**floorplan not to scale & layout has been modified*

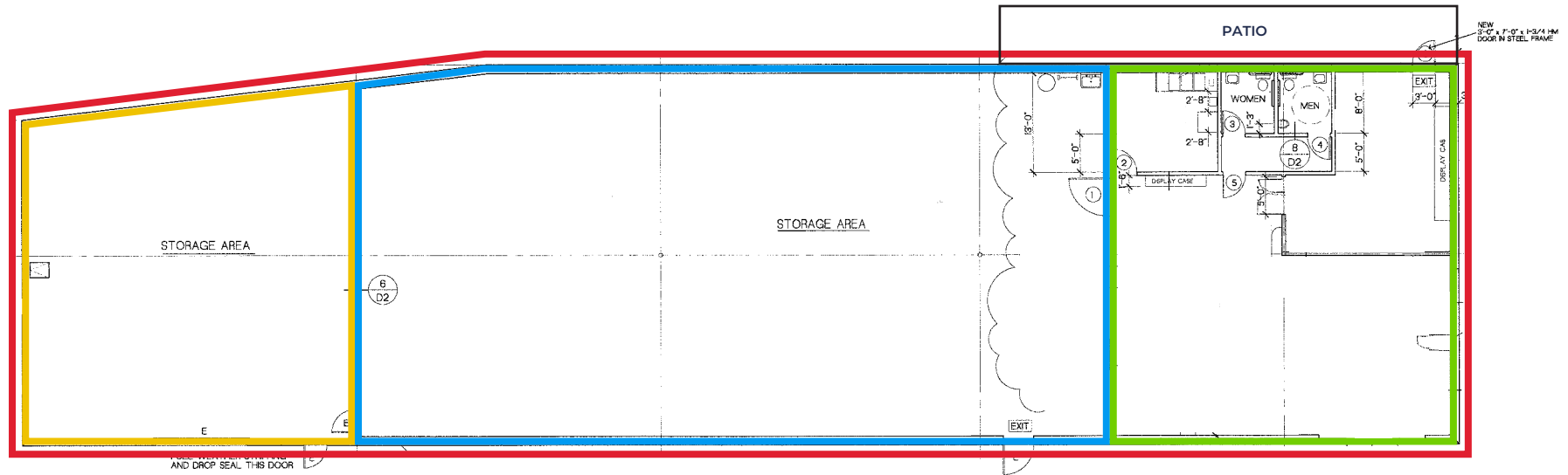

TOTAL
9,300 SF

UNIT 300
2,000 SF

UNIT 200
5,000 SF

UNIT 100
2,300 SF

**floorplan not to scale & layout has been modified*

YAIR HAIMOFF, SIOR
Executive Managing Director
818.203.5429
yhaimoff@spectrumcre.com
CA DRE Lic. #01414758

CONNOR QUAN
Senior Associate
818.935.2683
cquan@spectrumcre.com
CA DRE Lic. #02103887

No warranty, express or implied, is made as to the accuracy of the information contained herein. This information is submitted subject to errors, omission, change of price, rental or other conditions, withdrawal without notice, and is subject to any special listing conditions imposed by our principals. Cooperating brokers, buyers, tenants and other parties who receive this document should not rely on it, but should use it as a starting point of analysis, and should independently confirm the accuracy of the information contained herein through a due diligence review of the books, records, files and documents that constitute reliable sources of the information described herein. Spectrum Commercial Real Estate, Inc. CA DRE #02042805

SPECTRUM
COMMERCIAL REAL ESTATE, INC.
spectrumcre.com | 818.252.9900

26340 - 26370

DIAMOND PLACE

SANTA CLARITA, CA

AMENITIES MAP



YAIR HAIMOFF, SIOR
Executive Managing Director
818.203.5429
yhaimoff@spectrumcre.com
CA DRE Lic. #01414758

CONNOR QUAN
Senior Associate
818.935.2683
cquan@spectrumcre.com
CA DRE Lic. #02103887

No warranty, express or implied, is made as to the accuracy of the information contained herein. This information is submitted subject to errors, omission, change of price, rental or other conditions, withdrawal without notice, and is subject to any special listing conditions imposed by our principals. Cooperating brokers, buyers, tenants and other parties who receive this document should not rely on it, but should use it as a starting point of analysis, and should independently confirm the accuracy of the information contained herein through a due diligence review of the books, records, files and documents that constitute reliable sources of the information described herein. Spectrum Commercial Real Estate, Inc. CA DRE #02042805

SPECTRUM
COMMERCIAL REAL ESTATE, INC.
spectrumcre.com | 818.252.9900

26340 - 26370

DIAMOND PLACE

SANTA CLARITA, CA

FEATURES / HIGHLIGHTS**POPULATION**

	1 MILE	3 MILES	5 MILES
Estimated Population	2,732	105,753	222,306
Estimated Households	1,204	37,189	78,556

**HOUSEHOLD INCOME**

	1 MILE	3 MILES	5 MILES
Average Household Income	\$154,647	\$134,473	\$152,141
Median Household Income	\$107,360	\$106,327	\$120,604

**DAYTIME POPULATION**

	1 MILE	3 MILES	5 MILES
Total Businesses	601	4,512	9,745
Total Employees	5,903	33,306	76,127

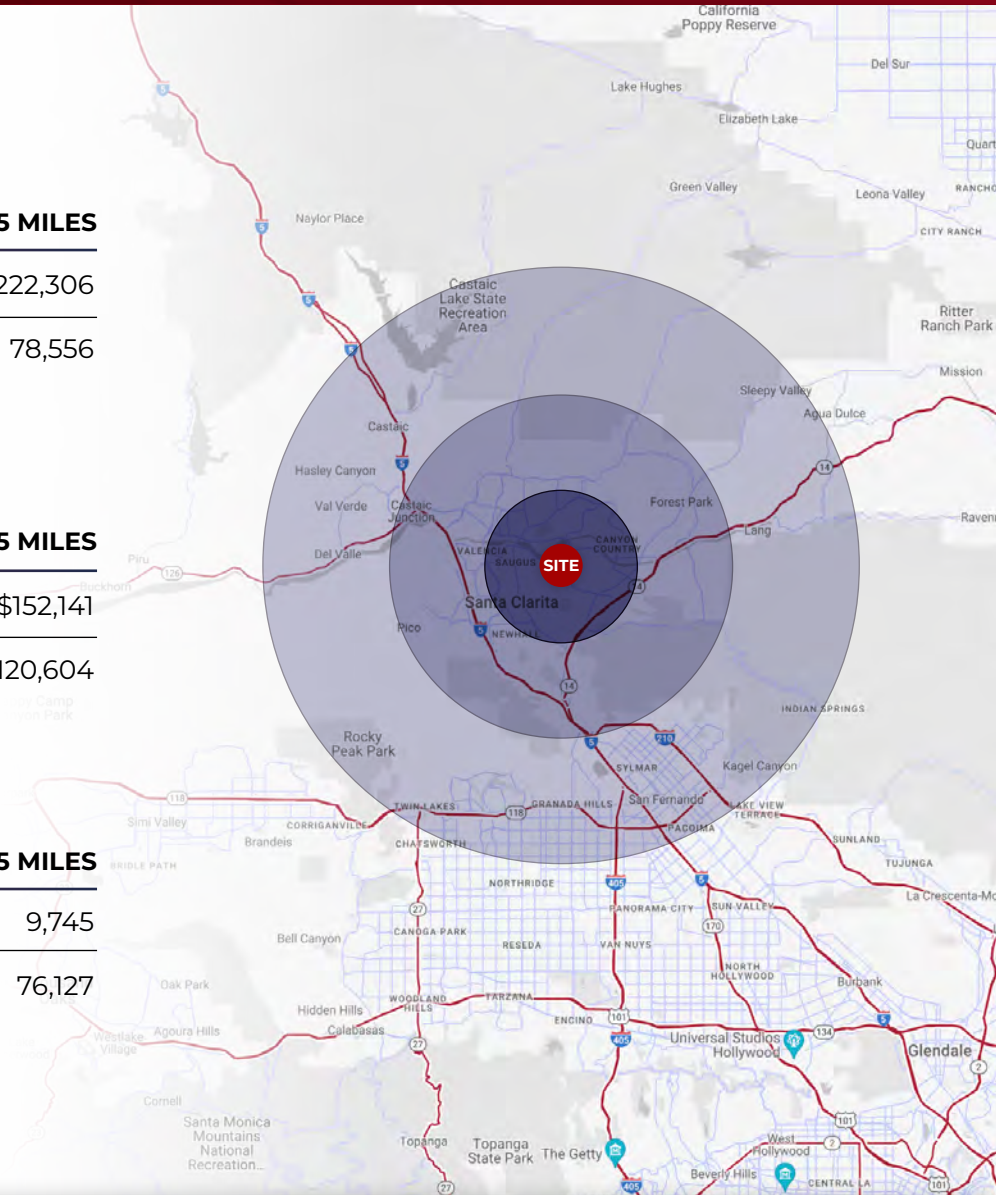
**YAIR HAIMOFF, SIOR**

Executive Managing Director

818.203.5429

yhaimoff@spectrumcre.com

CA DRE Lic. #01414758

CONNOR QUAN

Senior Associate

818.935.2683

cquan@spectrumcre.com

CA DRE Lic. #02103887

No warranty, express or implied, is made as to the accuracy of the information contained herein. This information is submitted subject to errors, omission, change of price, rental or other conditions, withdrawal without notice, and is subject to any special listing conditions imposed by our principals. Cooperating brokers, buyers, tenants and other parties who receive this document should not rely on it, but should use it as a starting point of analysis, and should independently confirm the accuracy of the information contained herein through a due diligence review of the books, records, files and documents that constitute reliable sources of the information described herein. Spectrum Commercial Real Estate, Inc. CA DRE #02042805

SPECTRUM
 COMMERCIAL REAL ESTATE, INC.

spectrumcre.com / 818.252.9900

26340 - 26370

DIAMOND PLACE

SANTA CLARITA, CA



YAIR HAIMOFF, SIOR

Executive Managing Director

818.203.5429

yhaimoff@spectrumcre.com

CA DRE Lic. #01414758



CONNOR QUAN

Senior Associate

818.935.2683

cquan@spectrumcre.com

CA DRE Lic. #02103887

SPECTRUM
— COMMERCIAL REAL ESTATE, INC.

spectrumcre.com | 818.252.9900

No warranty, express or implied, is made as to the accuracy of the information contained herein. This information is submitted subject to errors, omission, change of price, rental or other conditions, withdrawal without notice, and is subject to any special listing conditions imposed by our principals. Cooperating brokers, buyers, tenants and other parties who receive this document should not rely on it, but should use it as a starting point of analysis, and should independently confirm the accuracy of the information contained herein through a due diligence review of the books, records, files and documents that constitute reliable sources of the information described herein. Spectrum Commercial Real Estate, Inc. CA DRE #02042805